



Lucas Distribution, LLC

Operating Instructions Dongle Lockbox

www.papertraylock.com

* **Detaching Cable**

With the lock Dials set to the opening combination (note, factory default is 0-0-0-0), press the Black Release Button and slide the Hidden Lock Tab to unlock the Cable Bullet End from the Cable Locking Port. (See Figure 1).

* Combination lock should be removed from locking case.

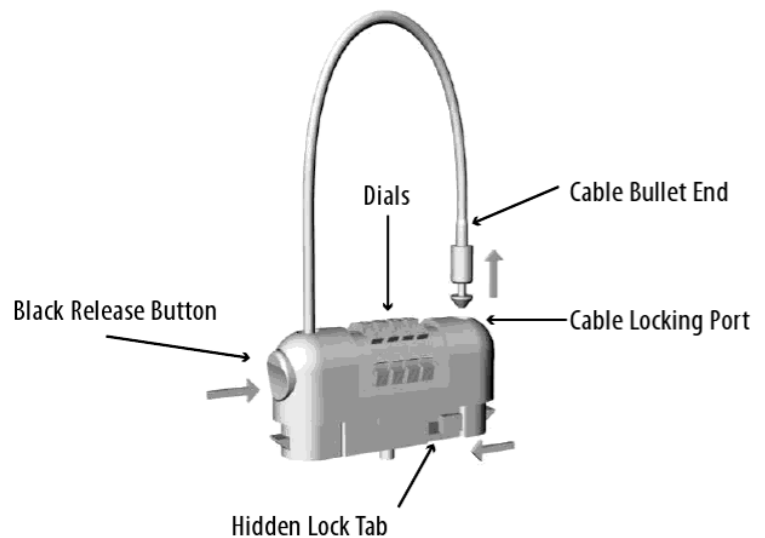

Figure 1

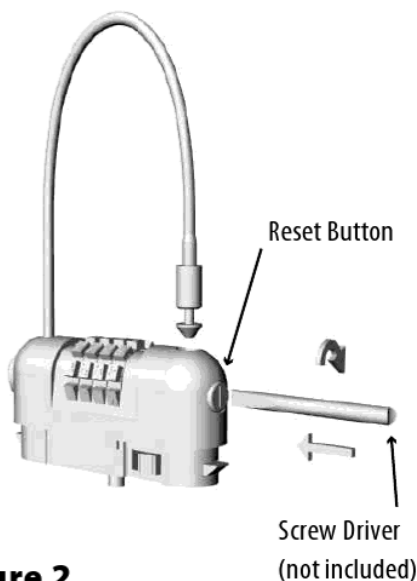

Figure 2

Setting Custom Combination

*With the lock detached from the housing and the Cable Bullet End detached, use a flat-head screwdriver (not included) to press in the Reset Button and turn 90 degrees clockwise. (See Figure 2) Turn Dials to your desired combination, turn Reset Button counter-clockwise 90 degrees so it pops back to its original position.

* Lock combination must be set to current unlock code in order to change combination.

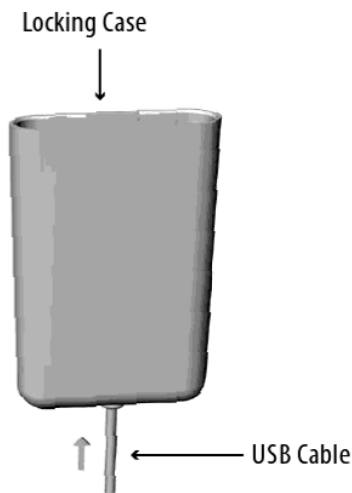

Figure 3

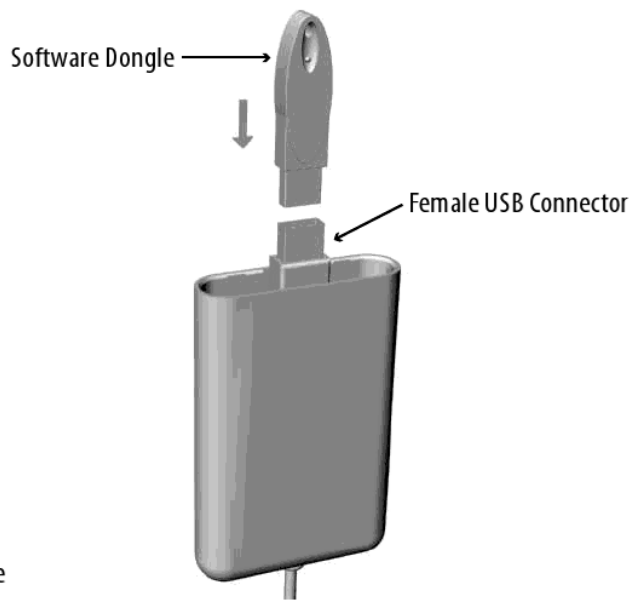

Figure 4



Figure 5

Securing Software Dongle

With the Combination Lock detached from the Locking Case, slide USB cable up (See Figure 3) so Female USB Connector is sticking out from open end of the Locking Case. Attach Software Dongle to Female USB Connector*(See Figure 4). Once connected, pull USB Cable down so Female USB Connector and Software Dongle are completely inside Locking Case. (See Figure 5).

*USB dongle must be 2 5/8" (66mm) or shorter to properly fit inside the Dongle Lockbox.

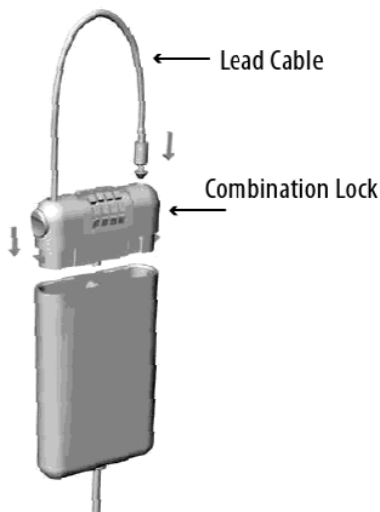

Figure 6

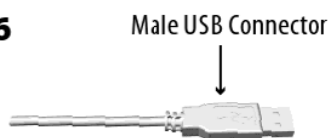

Figure 7

Closing Dongle Lockbox and Connecting To Computer

With Lead Cable fed through a secured anchor point, while pressing in Black Release Button, place Cable Bullet End into Cable Locking Port until it snaps. With Black Release Button still pushed in, attach Combination Lock to open end of Locking Case and release button. (See Figure 6) Attach Male USB Connector to open USB port on computer. (See Figure 7)

Lucas Distribution, LLC



Attaching Flex Pad

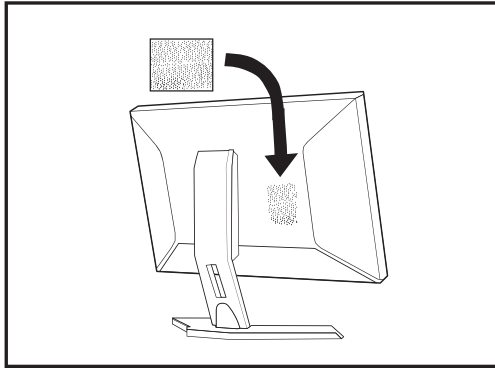

Scratch surface with sand paper where Flex Pad will be attached to component.

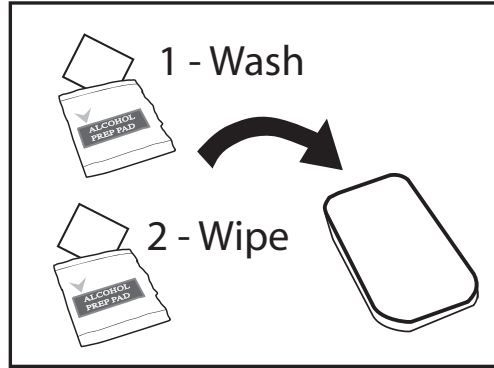

Clean bottom area of Flex Pad completely using alcohol pad.

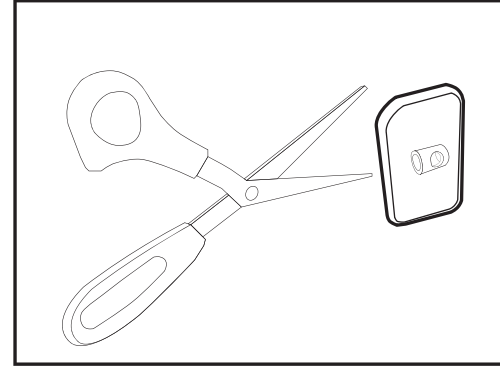

Trim Flex Pad if necessary.

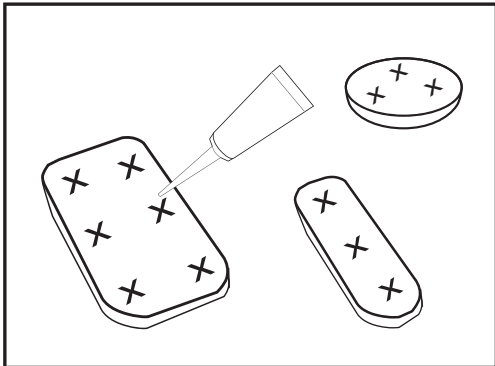

Place glue onto bottom of pad at various points only using a few drops for each.

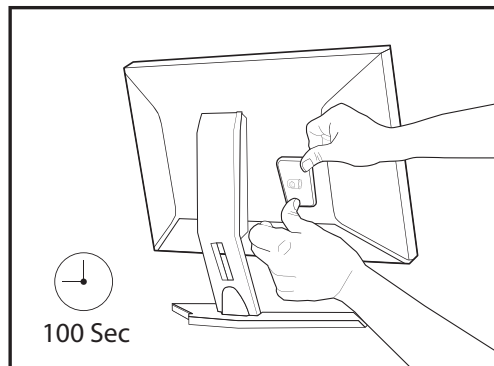

Using both hands, firmly press Flex Pad against surface for 100 seconds with equal pressure.

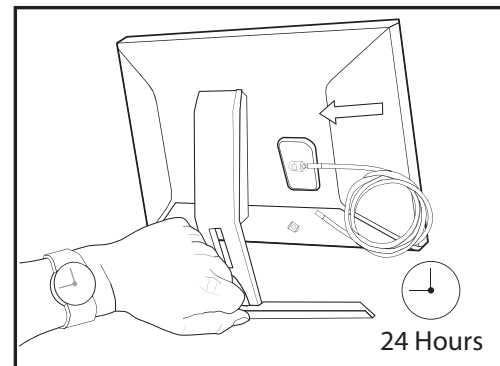

Allow 24 hours for the bond to cure. Then insert Cable through the Cable Nut on Flex Pad.

